

AUTOPARTS
warehouse

35
years
strong

March 2025

**SERVICE
IS THE
DIFFERENCE.**

**We
Get
It!**

Specializing in "Hard to Find" Import & Domestic Parts

MACPHERSON

Control Arms

25% OFF Per Pair!

MacPherson Ride Chassis is your go-to for trusted performance for all popular trucks & vehicles. MacPherson Control Arms are designed with improved dust boot designs and materials for superior performance. MacPherson Control Arms are built with Ultra-Guard Corrosion coating to prevent harmful rust buildup and increase part longevity.



MACPHERSON

Loaded Struts

25% OFF Per Pair!

MacPherson Struts offer premium quality at value pricing. Engineered based on OE. Endurance tested to ensure optimal performance & long life. Precision OE technology, design and hardware. Each assembly contains 100% new componentry including new springs, struts, mounts & hardware. Restores vehicle to ride "as good as new!"



POWERSTOP®

EVOLUTION PLUS
CERAMIC DISC BRAKE PADS WITH HARDWARE

**ONE
PRICE**

\$27.99!

- **Better Braking** - Thermal scorched for a faster break-in as well as chamfered and slotted to ensure noise-free braking.
- **Dependable Performance** - Delivers consistent wear and performance while the powder coated backing plate resists rust and corrosion.



**Some Exclusions Apply – Ask Your Salesperson for Details!*



UNITED

MOTOR PRODUCTS

IGNITION COILS

25% Full Set OFF Per Car!



- The outer shells of the epoxy filled coils are made with a high dielectric strength glass-filled PBT polymer that helps prevent current grounding associated with lower quality plastics used for economy grade coils.
- The wire is coated with a high strength enamel, to prevent shorts between the windings. This is extremely important when the vehicle's ignition system is under extreme ignition load.
- With these processes and procedures, along with the highest quality raw material available, you can be assured United coils provide the highest spark energy, maintain reliability and have an extended coil life!



IMC IMPORT
PARTS

Warehouse locations in PA and NJ!
Find one near you at eapw.com!

▲ STOCKED IN YOUR LOCAL EASTERN WAREHOUSE!

PERFECT STOP

- ▲ High Carbon Rotors
- ▲ Painted Rotors
- ▲ Brake Pads by Bosch
- ▲ Brake Fluid
- ▲ Brake Wear Sensors
- ▲ ABS Sensors
- ▲ Calipers
- ▲ Brake Boosters

MacPherson
MACPHERSON RIDE

- ▲ Shocks
- ▲ Hub Bearings
- ▲ Idler Arms
- ▲ Ball Joints
- ▲ Control Arms
- ▲ Struts

Belts

- Continental
- Dayco
- ▲ Gates
- Goodyear

Brakes

- Akebono
- Ate
- Bendix
- ▲ Better Brake Parts
- Bosch
- Brembo
- ▲ Carlson
- Centric
- Durago
- ▲ DFC
- Nu-Geon
- Pagid
- ▲ Perfectstop by Bosch
- ▲ Powerstop
- ▲ Quality Built
- ▲ Ultrastop
- Wagner

Chemicals

- ▲ CRC
- ▲ Idemitsu
- ▲ Liqui Moly
- ▲ Mobil 1
- ▲ Parts Master
- Pentosin
- ▲ Permatex
- ▲ Valvoline

Climate Control

- Behr/Hella
- CSF
- ▲ Denso
- Four Seasons
- ▲ GPD
- Mando
- Nissens
- ▲ OSC
- URO
- UAC

Clutch

- Aisin
- ▲ ATP
- Exedy
- Koyo
- ▲ LUK
- MEYLE
- OPparts
- Sachs
- SKF

Cooling

- ▲ Aisin
- Behr/Hella
- CSF
- ▲ Denso
- ▲ Hayden
- ▲ Gates
- GMB
- Graf
- ▲ MotoRad
- ▲ OSC
- URO
- Valeo
- Vernet

Engine, Gaskets, & Seals

- ▲ Aisin
- ▲ Anchor
- BorgWarner
- ▲ Bosch
- Clevite
- Corteco
- ▲ Cloyes
- DEA
- ▲ Delphi
- Febi
- ▲ Gates
- GMB
- INA
- ▲ Mahle
- ▲ Sealed Power
- URO
- Westar
- Erling
- Fel Pro
- ▲ Mahle
- ▲ National
- Victor Reinz
- Timken

Exhaust

- AP Exhaust
- ▲ Davico
- D.E.C.
- ▲ Nickson
- ▲ Walker

Filters

- Baldwin
- Bosch
- Denso
- ▲ Hengst
- Mahle
- ▲ Mann-Filter
- ▲ Premium Guard
- ▲ Parts Master
- ▲ Wix

Ignition

- AC Delco
- Autolite
- ▲ Bosch
- Bremi
- ▲ Delphi
- ▲ Denso
- Facet
- Hella
- ▲ Hitachi
- Motorcraft
- ▲ NGK
- ▲ Standard
- Walker
- VDO
- ▲ WAI
- ▲ United

Injection

- ▲ Bosch
- ▲ Delphi
- ▲ Denso
- ▲ GB Reman
- ▲ Hitachi
- Pierburg
- ▲ Standard

Rotating Electric

- ▲ Bosch
- ▲ Denso
- Hitachi
- ▲ Quality-Built
- Valeo
- Wilson
- WAI
- TYC

Steering, Suspension, & Undercar

- AAE
- ▲ Arnott Industries
- Bilstein
- CRP
- Delphi
- Febi
- Koni

Injection

- KYB
- Lemförder
- Lesjöfors
- ▲ MacPherson
- Maval
- ▲ Mevotech
- ▲ MOOG
- ▲ Monroe
- ▲ Superior Suspension
- ▲ BCA/NTN
- Febi
- ▲ GSP
- ▲ MacPherson

Rotating Electric

- ▲ National
- NSK
- Rein
- Sachs
- Schaffler
- SKF
- Timken
- Traktomotive
- WJB

Lighting

- Eagle Eye
- ▲ Grote
- Hella
- Osram/Sylvania
- ▲ Phillips
- TYC
- Valeo
- Wagner

Relays, Sensors, & Switches

- ▲ Autel
- ▲ Bosch
- ▲ Denso
- ▲ Hella
- ▲ Hitachi
- ▲ Holstein
- ▲ Huco
- NTK
- VDO
- ▲ Schrader
- ▲ United
- Valeo
- ▲ Walker



VARIABLE VALVE TIMING SOLENOIDS AND SPROCKETS

Standard's VVT Sprockets help maximize horsepower and torque curves while reducing emissions and improving vehicle efficiency. Standard's VVT Sprockets meet tight dimensional tolerances to improve internal sealing, minimize oil drain back and reduce frequency of PCM correction.

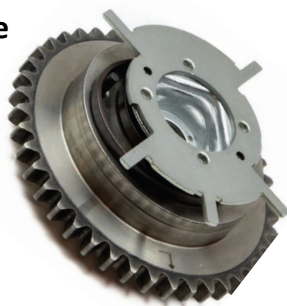

Standard's VVT Solenoids are built with hardened steel components to limit sticking during sludge buildup. Premium O-Rings and gaskets properly maintain oil pressure and prevent premature leaks. Each VVT Solenoid undergoes stringent quality control measures and end-of-line testing.



Rear & Beam Wiper Blades

AS LOW AS \$5.89!

Premium Vision Wiper Blades are engineered to deliver exceptional clarity, durability, and performance for a wide range of vehicle types and driving conditions. From your original beam and conventional styles to specialized rear blades, each is designed with advanced materials and innovative features to ensure optimal visibility and reliability. With a comprehensive selection of sizes and adapters, Premium Vision provides the perfect solution for every driver's needs.

Purchase 50 Premium Guard Beam Blades and receive a **FREE** Rear Blade Assortment!
**Reach Out to Your Sales Rep for Details!*



COOLANT RESERVOIR TANKS

- Designed to meet/exceed OE form and function.
- High quality construction with OE grade materials resistant to heat, corrosion, and vibration!
- Pressure and Leak tested on every new design; Metal insert in hose nipple to help reduce risk of leaks.
- GPD's Coolant Reservoir Tanks come with cap and coolant level sensor.



What Causes a Coolant Reservoir Tank to Leak?
The engine coolant reservoir tank can leak due to the constant cycle of heating and cooling of an engine causing the plastic to expand and contract. Over time, the stress weakens the material, leading to cracks and leaks.



BETTER BRAKE PARTS

BRAKE HARDWARE KITS

- ✓ Quality, Precision, and Reliability in Every Component!
- ✓ Over 700 Part Numbers in Stock!
- ✓ OE Quality – Using Stainless Steel Clips in Every Kit!
- ✓ In-House Design and Engineering Components are designed with strict OE Form, Fit, and Function.
- ✓ Components are Quality Tested for Dimensional & Material Integrity.



TECHNICIAN TRAINING!

Refresh your automotive A/C knowledge and keep up with A/C system and refrigerant changes and trends in-depth Automotive A/C Training seminar. In this class you will learn about new A/C technology, new refrigerants, A/C system design changes, temperature vs. pressure diagnosis, compressor types and compressor fail analysis, condenser designs, replacement and flushing, thermistor control functions, testing and troubleshooting, changes in electrical controls, and how to point out recent trends and diagnostic tips in specific components and vehicles.

TOMS RIVER
Tuesday, April 8th
Toms River Elks Lodge
600 Washington St.
Toms River, NJ 08753

LANGHORNE
Wednesday, April 9th
EAPW
355 S. Flowers Mill Road
Langhorne, PA 19047



The University of the Aftermarket will once again host the Auto Value and Bumper to Bumper scholarship program in 2025. This site facilitates scholarships throughout the entire automotive aftermarket, allowing employees and children to apply both for Auto Value and Bumper to Bumper scholarships and other industry scholarships at the same time. Please fill out the scholarship application and the registration form in their entirety and submit no later than March 31, 2025.

PERFECTSTOP™ CALIPERS

WALKER CATALYTIC CONVERTERS

✓ Armor-Plate Anti-Corrosion Coating

- E-Coat dip process provides **Inside & Out** protection for the caliper and its critical surfaces.

✓ Proprietary Piston Movement Test

- Ensures proper functioning pistons for every installation.

✓ Best Coverage

- Ensures comprehensive coverage all foreign and domestic vehicles, including everything you need in one box!



Manufactured with a stainless-steel body and aluminized pipe, the Walker direct-fit catalytic converter is designed for easy installation with OE-style hangers, brackets, and heat shield.

DIRECT-FIT CATALYTIC CONVERTERS

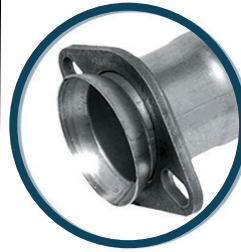

Easy to Install - Bolt-on replacement solution with OE-style hangers, brackets, routings, and heat shields for easy installation and doesn't require fabrication or welding.



DAVICO CATALYTIC CONVERTERS

Davico Manufacturing's EPA Direct Fit Catalytic Converters are made to high standards to replace a failed, damaged or missing original equipment Catalytic Converter.

- Made in the USA!
- Family owned and operated!
- Founded in 1987!
- Stocking 600 Part Numbers!
- Made to high standards to replace a failed, damaged or missing original equipment (OE) Catalytic Converter.



Win a VIP Driving Experience!



MYPLACE4PARTS USERS ARE ENTERED AUTOMATICALLY!
Fall Trip: Oct. 15-18, 2025



GRAND PRIZE WINNERS WILL WIN A DRIVING EXPERIENCE WEEKEND OUT IN CHANDLER, AZ AT THE RADFORD RACING PERFORMANCE SCHOOL!

Promo runs from March 1st to April 30th

Visit <https://roadwarriorweekend2025.com/> for official rules

March Manufacturer Price Updates

BBB STEERING – 3/3/25

BBB TURBOS – 3/3/25

NGK – 3/4/25

STANDARD – 3/17/25

GATES – 3/20/25

Tariff Manufacturer Price Updates

MEVOTECH – 3/3/25

MACPHERSON CHASSIS – 3/3/35

MPA ROTATING ELECTRIC – 3/4/24

MACPHERSON HUBS – 3/4/25

PERFECTSTOP – 3/4/25

POWERSTOP – 3/5/25

GPD – 3/15/25